

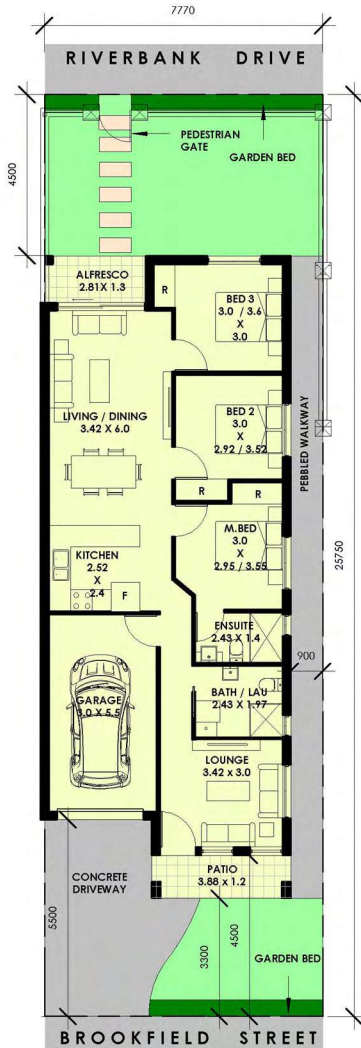

HOME & LAND PACKAGE



HOUSE

3BR with Alfresco
 Ground Floor - 116.75m²
 Squares - 12.56

NORTH

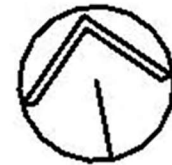

KEY FEATURES

- Premium 'The Ponds' location
- Torrens title home and land package
- North facing living areas and yards
- Directly opposite 2 schools
- Vehicular access through quiet Brookfield Street
- Bus stop approx. within 100m
- Direct pedestrian access to Riverbank drive
- Full turn-key inclusions including 2.7m high ceilings; refer to brochure

CORNER OF RIVERBANK DRIVE
& HAMBLEDON ROAD, THE PONDS

7770

RIVERBANK DRIVE

4500

PEDESTRIAN GATE
GARDEN BED

ALFRESCO
2.81 X 1.3

BED 3
3.0 / 3.6
X
3.0

LIVING / DINING
3.42 X 6.0

BED 2
3.0
X
2.92 / 3.52

PEBBLED WALKWAY

KITCHEN
2.52
X
2.4 F

M.BED
3.0
X
2.95 / 3.55

25750

ENSUITE
2.43 X 1.4

900



GARAGE
3.0 X 5.5

BATH / LAU
2.43 X 1.97

LOUNGE
3.42 x 3.0

CONCRETE DRIVEWAY

PATIO
3.88 x 1.2

5500

3300
4500

GARDEN BED

NORTH



BROOKFIELD STREET