

# Chelsea



FACADE UPGRADE - CONTEMPORARY



FACADE UPGRADE - VOGUE

## Classic Range Features

- Coloured concrete driveway
- Ceramic tiles to porch
- Laminate timber covering to hallway, kitchen and main living area
- Carpet to all other areas
- Pine architraves & skirting
- 20mm stone kitchen bench top
- 20mm stone bench top to en-suite, bathroom, powder-room & laundry
- SMEG 600mm cook-top
- SMEG 600mm oven
- SMEG 600mm range-hood
- Freestanding bath
- Semi frameless shower screens
- Ducted air conditioner
- Internal access door from garage to house
- NBN provision
- Colorbond roof with insulation blanket
- Colorbond fasci and gutter
- Continuous flow gas hot water system
- R2.0 Insulation to walls
- R3.0 Insulation to ceilings excluding garage, patio & alfresco (accordance to house design)

 4 | 
  2 | 
  1

Photographs in this brochure may depict fixtures, finishes and features not supplied by Reward Homes such as landscaping and fencing.

# Chelsea

 4 | 
  2 | 
  1

fits  
**9m-9.5m\***  
block width

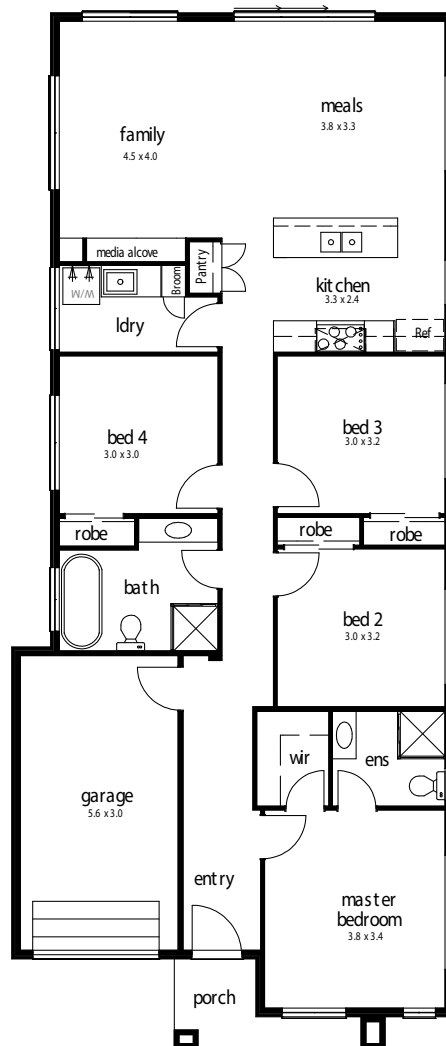

## HOUSE AREA

|              |                 |
|--------------|-----------------|
| GROUND FLOOR | 127.9           |
| FIRST FLOOR  | n/a             |
| GARAGE       | 18.4            |
| PORCH        | 4.1             |
| ALFRESCO     | n/a             |
| <b>TOTAL</b> | <b>150.4 m2</b> |



CLASSIC FACADE - TRADITIONAL 1



CLASSIC FACADE - TRADITIONAL 2



This floor plan is subject to change, orientation and fall of land and developer and council guidelines. Under no circumstances will Dré Diesel and Reward Parties be liable for any direct, indirect, consequential, incidental, special, punitive or exemplary damages of any kind, including, without limitation, any loss of profits, loss of opportunity arising out of or in connection to information provided in this floor plan, regardless of whether the Reward Parties have been apprised of the likelihood of such damages occurring and regardless of the form of action, whether in arising from the breach of contract, warranty, tort (including negligence), strict liability or otherwise, even if such loss or damage could have been reasonably foreseen.