





**WATERFALL**  
BY CROWN GROUP

## Two Bedroom + Flexi

Revised 26.05.17 | No.10-



0 2m

### BUILDING D

Apartments: D206, D306, D506, D606, D706, D806

|          |        |
|----------|--------|
| Total    | 86 sqm |
| Internal | 78 sqm |
| External | 8 sqm  |

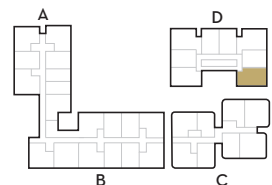

**Disclaimer:** The information and illustrations in this document are indicative only and are subject to change. Crown W1 Pty Limited, Sathio Investments Pty Limited, Crown Cornerstone Investments Pty Limited and Crown W1 Developments Pty Limited and their related entities or corporations (including the landowner) and their agents do not warrant the accuracy of and do not accept any liability for any error or discrepancy in the information and illustrations. Any furniture depicted is illustrative only and will not form part of the property sold. The displayed information and illustrations do not form part of any contract for sale, and interested parties must rely on their own enquiries and the information in the contract for sale.



# Schedule Of Finishes

## *Residential Apartments*

# Schedule Of Finishes

## *One Bed Suite*

| Kitchens  | Bathrooms  | Apartments General   |
|---|--|--|
| Floor tiles   | Floor and wall tiles                                       | Built-in wardrobes with timber laminate doors  |
| Re-constituted stone bench tops   | Painted plasterboard ceiling                               | Floor tiles  |
| Miele rangehood   | Recessed mirror splashback                                 | Painted plasterboard walls   |
| Miele stainless steel four burner gas cooktop   | Soft close timber laminate vanity cupboards                | Painted plasterboard ceiling   |
| Miele compact oven (convection type oven)   | Soft close mirror vanity cupboards                         | Ducted Air Conditioning  |
| Fisher and Paykel fully-integrated dishdrawer   | Re-constituted stone shelf                                 | Recessed LED downlights  |
| Under-mount stainless steel sink (single bowl)  | Wall mounted basin   | Stainless steel laundry tub with reconstituted stone top or stainless steel tub with cabinet |
| Chrome single lever kitchen mixer   | Chrome single lever basin mixer                            | Chrome laundry mixer   |
| Soft closing doors and drawers. Finish; timber laminate drawers & cupboards, polyurethane overhead and underbench cupboards and drawers | Chrome bathroom accessories                                | Wall mounted washing machine and clothes dryer   |
| Toughened mirror splashback   | Chrome handheld shower on rail                             | Tiles to balconies   |
| LED feature strip lighting  | Floor mounted pan with in-wall cistern and soft close seat | Electronic security system to building with AV intercom in each apartment                    |
|   | Frameless shower screen                                    | TV, telephone and data outlets, GPOs and Fibre connection box                                |
|   | LED feature strip lighting                                 |  |
|   | Externally ducted exhaust fan                              |  |

## 18-20 O'Dea Avenue, Waterloo Standard Apartment Finishes And Inclusions

**Upgrade Option (If Applicable):** Platinum Home Package comprising motorised blinds; built in multimedia touch screen which controls lighting On/Off; LED light dimming; remote blind control; air conditioning control; energy consumption monitoring; local intercom control; and multiple option home lighting and blind control

# Schedule Of Finishes

*One Bedroom + Study / One Bedroom + Flexi*

| Kitchens  | Bathrooms  | Apartments General  |
|---|--|---|
| Floor tiles   | Floor and wall tiles                                       | Built-in wardrobes with soft close polyurethane doors   |
| Re-constituted stone bench tops   | Painted plasterboard ceiling                               | Tiles to kitchen floor  |
| Miele rangehood   | Recessed mirror splashback                                 | Carpet to living, dining, and Bedroomroom floors  |
| Miele stainless steel four burner gas cooktop   | Soft close timber laminate vanity cupboards                | Painted plasterboard walls  |
| Miele stainless steel electric oven   | Soft close mirror vanity cupboard                          | Painted plasterboard ceiling  |
| Miele stainless steel microwave oven with trim kit  | Re-constituted stone shelf                                 | Zoned Air Conditioning  |
| Miele semi-integrated dishwasher  | Wall mounted basin   | Recessed LED downlights   |
| Under-mount, stainless steel sink (one bowl)  | Chrome single lever basin mixer                            | Stainless steel laundry tub with reconstituted stone top or stainless steel tub with cabinet (refer to floorplan for details) |
| Chrome single lever kitchen mixer   | Chrome bathroom accessories                                | Chrome laundry mixer  |
| Soft closing doors and drawers. Finish; timber laminate drawers & cupboards, polyurethane overhead and underbench cupboards and drawers | Chrome handheld shower on rail                             | Wall mounted washing machine and clothes dryer  |
| Toughened mirror splashback   | Floor mounted pan with in-wall cistern and soft close seat | Tiles to balconies  |
| LED feature strip lighting  | Frameless shower screen                                    | Electronic security system to building with AV intercom in each apartment   |
|   | LED feature strip lighting                                 | TV, telephone and data outlets, GPOs and Fibre connection box   |
|   | Externally ducted exhaust fan                              |   |

## 18-20 O'Dea Avenue, Waterloo Standard Apartment Finishes And Inclusions

**Upgrade Option (If Applicable):** Platinum Home Package comprising motorised blinds; built in multimedia touch screen which controls lighting On/Off; LED light dimming; remote blind control; air conditioning control; energy consumption monitoring; local intercom control; and multiple option home lighting and blind control

# Schedule Of Finishes

*Two Bedroom / Two Bedroom + Flexi / Two Bedroom + Study*

| Kitchens  | Bathrooms  | Apartments General  |
|---|--|---|
| Floor tiles   | Floor and wall tiles                                       | Built-in wardrobes with soft close polyutherane doors   |
| Re-constituted stone bench tops   | Painted plasterboard ceiling                               | Tiles to kitchen floor  |
| Miele rangehood   | Recessed mirror splashback                                 | Carpet to living, dining, and Bedroomroom floors  |
| Miele stainless steel four burner gas cooktop   | Soft close timber laminate vanity cupboards                | Painted plasterboard walls  |
| Miele stainless steel electric oven   | Soft close mirror vanity cupboard                          | Painted plasterboard ceiling  |
| Miele stainless steel microwave oven with trim kit  | Re-constituted stone shelf                                 | Zoned Air Conditioning  |
| Miele semi-integrated dishwasher  | Wall mounted basin   | Recessed LED downlights   |
| Under-mount, stainless steel sink (one or one and a half bowl refer to floor plan for details)  | Chrome single lever basin mixer                            | Stainless steel laundry tub with reconstituted stone top or stainless steel tub with cabinet (refer to floorplan for details) |
| Chrome single lever kitchen mixer   | Chrome bathroom accessories                                | Chrome laundry mixer  |
| Soft closing doors and drawers. Finish; timber laminate drawers & cupboards, polyurethane overhead and underbench cupboards and drawers | Chrome handheld shower on rail                             | Wall mounted washing machine and clothes dryer  |
| Toughened mirror splashback   | Floor mounted pan with in-wall cistern and soft close seat | Tiles to balconies  |
| LED feature strip lighting  | Frameless shower screen                                    | Electronic security system to building with AV intercom in each apartment   |
|   | LED feature strip lighting                                 | TV, telephone and data outlets, GPOs and Fibre connection box   |
|   | Externally ducted exhaust fan                              |   |

## 18-20 O'Dea Avenue, Waterloo Standard Apartment Finishes And Inclusions

**Upgrade Option (If Applicable):** Platinum Home Package comprising motorised blinds; built in multimedia touch screen which controls lighting On/Off; LED light dimming; remote blind control; air conditioning control; energy consumption monitoring; local intercom control; and multiple option home lighting and blind control

# Schedule Of Finishes

## Three Bedroom

| Kitchens  | Bathrooms  | Apartments General  |
|---|--|---|
| Floor tiles   | Floor and wall tiles                                       | Built-in wardrobes with soft close polyutherane doors   |
| Re-constituted stone bench tops   | Painted plasterboard ceiling                               | Tiles to kitchen floor  |
| Miele rangehood   | Recessed mirror splashback                                 | Carpet to living, dining, and Bedroomroom floors  |
| Miele stainless steel four burner gas cooktop   | Soft close timber laminate vanity cupboards                | Painted plasterboard walls  |
| Miele stainless steel electric oven   | Soft close mirror vanity cupboard                          | Painted plasterboard ceiling  |
| Miele stainless steel microwave oven with trim kit  | Re-constituted stone shelf                                 | Zoned Air Conditioning  |
| Miele semi-integrated dishwasher  | Wall mounted basin   | Recessed LED downlights   |
| Under-mount, stainless steel sink (one and a half bowl)   | Chrome single lever basin mixer                            | Stainless steel laundry tub with reconstituted stone top or stainless steel tub with cabinet (refer to floorplan for details) |
| Chrome single lever kitchen mixer   | Chrome bathroom accessories                                | Chrome laundry mixer  |
| Soft closing doors and drawers. Finish; timber laminate drawers & cupboards, polyurethane overhead and underbench cupboards and drawers | Chrome handheld shower on rail                             | Wall mounted washing machine and clothes dryer  |
| Toughened mirror splashback   | Floor mounted pan with in-wall cistern and soft close seat | Tiles to balconies  |
| LED feature strip lighting  | Frameless shower screen                                    | Electronic security system to building with AV intercom in each apartment   |
|   | LED feature strip lighting                                 | TV, telephone and data outlets, GPOs and Fibre connection box   |
|   | Externally ducted exhaust fan                              |   |

## 18-20 O'Dea Avenue, Waterloo Standard Apartment Finishes And Inclusions

**Upgrade Option (If Applicable):** Platinum Home Package comprising motorised blinds; built in multimedia touch screen which controls lighting On/Off; LED light dimming; remote blind control; air conditioning control; energy consumption monitoring; local intercom control; and multiple option home lighting and blind control

# Schedule Of Finishes

## *Penthouses*

| Kitchens  | Ensuite   | Bathrooms  |
|---|---|--|
| Floor tiles   | Floor and wall tiles  | Floor and wall tiles                                       |
| Stone bench tops  | Painted plasterboard ceiling                                      | Painted plasterboard ceiling                               |
| Externally ducted Miele rangehood   | Mirror splashback   | Recessed brushed metal laminate splashback                 |
| Miele stainless steel 5 burner gas cooktop  | Soft close mirror vanity cupboards                                | Soft close laminate cupboards                              |
| Miele stainless steel pyrolytic electric oven   | Feature leather vanity surrounds                                  | Soft close mirror vanity cupboard                          |
| Miele compact oven (convection type oven)   | Re-constituted stone benchtop                                     | Re-constituted stone shelf                                 |
| Miele built-in gourmet drawer (warming drawer)  | Double above counter basins                                       | Wall mounted basin   |
| Miele fully-integrated full-height dishwasher   | Chrome single lever basin mixers                                  | Chrome single lever basin mixer                            |
| Fisher & Paykel fridge/freezer with integration kit   | Chrome bathroom accessories                                       | Chrome bathroom accessories                                |
| Under-mount stainless steel sink (double bowl)  | Rain shower head  | Chrome handheld shower on rail                             |
| Chrome single lever kitchen mixer   | Chrome hand-held shower   | Floor mounted pan with in-wall cistern and soft close seat |
| Soft closing doors and drawers. Finish: polyurethane to island bench, with feature tile to full-height and overhead cupboards | Floor mounted toilet pan with in-wall cistern and soft close seat | Frameless shower screen                                    |
| Toughened mirror splashback & surround  | Frameless shower screens & toilet cubicle                         | LED feature strip lighting                                 |
| LED feature strip lighting  | Free-standing bath  |  |
|   | Wall mounted bath spout with hand-held shower                     |  |
|   | Externally ducted exhaust fan                                     |  |
|   | LED feature strip lighting  |  |



# Schedule Of Finishes

## *Penthouses (continued)*

| Apartment General   |   |
|---|---|
| Built-in wardrobes with soft close polyurethane doors to bedroom      | GPO, gas and water outlet to balconies                                    |
| Floors: Tiles to kitchen, living and dining                           | Electronic security system to building with AV intercom in each apartment |
| 100% wool carpet to Bedroomrooms                                      | Platinum Home Automation Package  |
| Feature leather wall panelling to master Bedroomroom robe & ensuite   | Integrated sound system   |
| Painted plasterboard walls  | TV, telephone and data outlets, GPOs and Fibre connection box             |
| Painted plasterboard ceiling  |   |
| Zoned Air Conditioning  |   |
| Recessed LED downlights   |   |
| Under-mount, stainless steel laundry tub                              |   |
| Laundry cupboard with overhead storage & reconstituted stone benchtop |   |
| Chrome laundry mixer  |   |
| Washing machine and wall mounted clothes dryer                        |   |
| Tiles to balconies  |   |

## 18-20 O'Dea Avenue, Waterloo Standard Apartment Finishes And Inclusions

**Upgrade Option (If Applicable):** Platinum Home Package comprising motorised blinds; built in multimedia touch screen which controls lighting On/Off; LED light dimming; remote blind control; air conditioning control; energy consumption monitoring; local intercom control; and multiple option home lighting and blind control

# Schedule Of Finishes

## *Super Penthouse*

| Kitchens  | Ensuite   | Bathrooms  |
|---|---|--|
| Floor tiles   | Floor and wall tiles  | Floor and wall tiles                                       |
| Stone bench tops  | Painted plasterboard ceiling                                      | Painted plasterboard ceiling                               |
| Externally ducted Miele rangehood   | Mirror splashback   | Recessed brushed metal laminate splashback                 |
| Miele stainless steel 5 burner gas cooktop  | Soft close mirror vanity cupboards                                | Soft close laminate cupboards                              |
| Miele stainless steel pyrolytic electric oven   | Feature leather vanity surrounds                                  | Soft close mirror vanity cupboard                          |
| Miele compact oven (convection type oven)   | Re-constituted stone benchtop                                     | Re-constituted stone shelf                                 |
| Miele built-in gourmet drawer (warming drawer)  | Double above counter basins                                       | Wall mounted basin   |
| Miele fully-integrated full-height dishwasher   | Chrome single lever basin mixers                                  | Chrome single lever basin mixer                            |
| Fisher & Paykel fridge/freezer with integration kit   | Chrome bathroom accessories                                       | Chrome bathroom accessories                                |
| Under-mount stainless steel sink (double bowl)  | Rain shower head  | Chrome handheld shower on rail                             |
| Chrome single lever kitchen mixer   | Chrome hand-held shower   | Floor mounted pan with in-wall cistern and soft close seat |
| Soft closing doors and drawers. Finish: polyurethane to island bench, with feature tile to full-height and overhead cupboards | Floor mounted toilet pan with in-wall cistern and soft close seat | Frameless shower screen                                    |
| Toughened mirror splashback & surround  | Frameless shower screens & toilet cubicle                         | LED feature strip lighting                                 |
| LED feature strip lighting  | Free-standing bath  |  |
|   | Wall mounted bath spout with hand-held shower                     |  |
|   | Externally ducted exhaust fan                                     |  |
|   | LED feature strip lighting  |  |

# Schedule Of Finishes

## *Super Penthouse (continued)*

| Apartment General   |   |
|---|---|
| Built-in wardrobes with soft close polyurethane doors to bedroom      | GPO, gas and water outlet to balconies                                    |
| Floors: Tiles to kitchen, living and dining                           | Electronic security system to building with AV intercom in each apartment |
| 100% wool carpet to Bedroomrooms                                      | Platinum Home Automation Package  |
| Feature leather wall panelling to master Bedroomroom robe & ensuite   | Integrated sound system   |
| Painted plasterboard walls  | TV, telephone and data outlets, GPOs and Fibre connection box             |
| Painted plasterboard ceiling  |   |
| Zoned Air Conditioning  |   |
| Recessed LED downlights   |   |
| Under-mount, stainless steel laundry tub                              |   |
| Laundry cupboard with overhead storage & reconstituted stone benchtop |   |
| Chrome laundry mixer  |   |
| Washing machine and wall mounted clothes dryer                        |   |
| Tiles to balconies  |   |

## 18-20 O'Dea Avenue, Waterloo Standard Apartment Finishes And Inclusions

**Upgrade Option (If Applicable):** Platinum Home Package comprising motorised blinds; built in multimedia touch screen which controls lighting On/Off; LED light dimming; remote blind control; air conditioning control; energy consumption monitoring; local intercom control; and multiple option home lighting and blind control