

# LOT 2123

4 2 1

LAND SIZE 284m<sup>2</sup>

GROUND FLOOR	114.72m <sup>2</sup>
GARAGE	18.52m <sup>2</sup>
PORCH	1.55m <sup>2</sup>
<b>GROSS FLOOR AREA</b>	<b>134.79m<sup>2</sup></b>

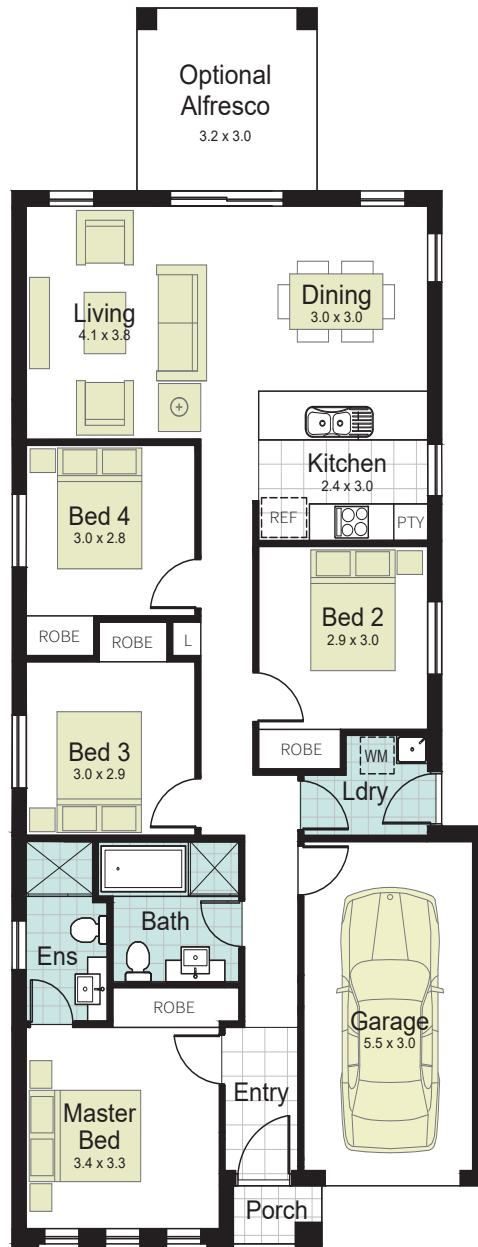

GROUND FLOOR

Call **0432 428 899** or visit **albertparkboxhill.com.au**

© \*All drawings and photography are for illustrative purposes and should be used as a guide only. Goldmate Group and their builder partners reserve the right to withdraw packages, revise plans, specifications and pricing without notice or obligation. Copyright of plans and documentation procured by Goldmate Group and their builder partners shall remain the exclusive property of the producing or procuring entity unless a license is issued otherwise. This house and land package is inclusive of GST. Goldmate Group and their builder partners have made all reasonable efforts to ensure the accuracy of this package flyer. It is recommended that the purchaser make their own enquiries in relation to this product offering and review their tender documentation with due care. Information and pricing are correct as at 13th March 2020. Changes can be accommodated to the package as requested by the purchaser subject to permissibility, however any changes as directed by the purchaser will be at their own cost. Deziire Homes ABN 81 617 178 015. Builders Licence 310234C. Goldmate Group Pty Ltd. ABN 22 169 892 111.