

DISCLOSURE PLAN

FOR PROPOSED LOT 14

Proposed Lot 14 is currently described as part of Lot 15 on RP899708 situated at Koplick Road, Park Ridge.

LEGEND

- +6.0--- DESIGN FILL CONTOUR (0.5m INTERVAL)
- 10.0—— DESIGN F.S.L. SURFACE LEVEL CONTOUR (0.5m INTERVAL)
- AREA OF FILL
- FOR RETAINING WALL CONSTRUCTION DETAIL
SEE ENGINEERING CIVIL O.P.W. PLANS

Builders Note:

Builders shall not build off the design levels shown; a site survey is required. This note is an integral part of this plan.

Engineering Note:

Engineering design information supplied by PeakUrban. August 2019.

Compaction Statement:

All earthworks shall be undertaken in accordance with AS3798:2007 and local authority requirements, including Level 1 supervision.

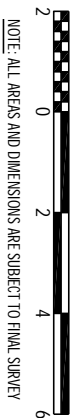

Local Authority : Logan City	
Height Datum : AHD	
Height Origin: PM153245 RL 42.221	
Contour Interval : 0.5 m	
Horizontal Meridian: MGA (Zone 56)	
ENG : Disclosure Info_20190808	
BDY : 138567 Bdy (2019-08-22)	
Surveyor: RPS GC	
Drawn : BJB	
Scale : 1:150 @ A3	
Date: 22 AUGUST 2019	
Dwg No: 144169-DISC-1/14	

Koplick Developments Pty Ltd



RPS Australia East Pty Ltd
ACN 140 292 762
ABN 44 140 292 762
Lakeside Corporate Space, Suite 425, Level 2
Building 4, 34-36 Glenferrie Drive,
Rusland PO Box 1048 Rusland VIC, Qld 4226

T +61 7 555 36900
F +61 7 555 36999
W rpsgroup.com

©COPYRIGHT PROTECTS THIS PLAN
Unauthorized reproduction or amendment
not permitted. Please contact the author.

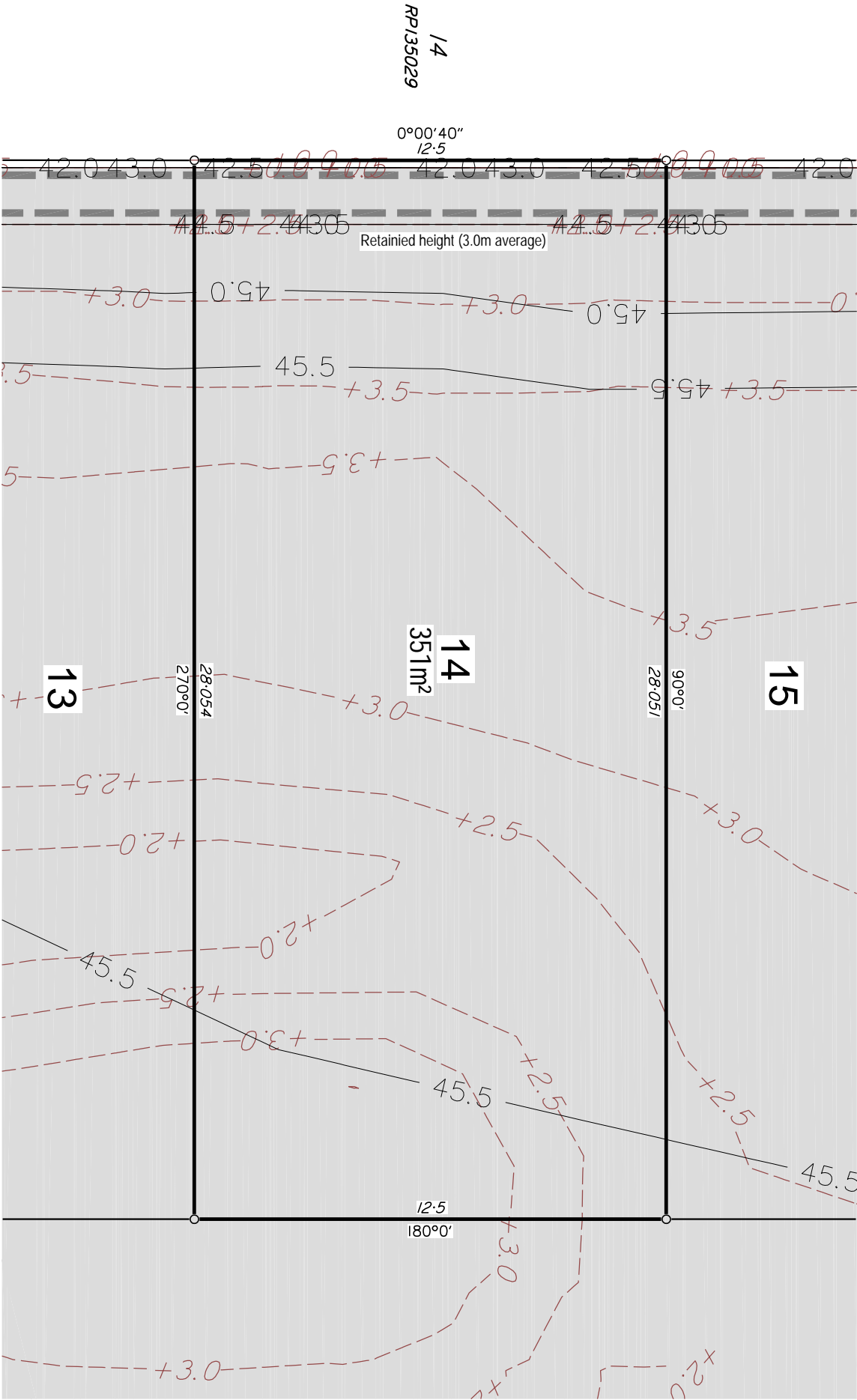

ROAD NAME

Note:

This plan has been prepared by RPS Australia East Pty Ltd (ACN 140 292 762), which is registered with the Surveyors Board of Queensland as a Cadastral Surveyor.

DISCLOSURE PLAN

FOR PROPOSED LOT 15

Proposed Lot 15 is currently described as part of Lot 15 on RP899708 situated at Koplick Road, Park Ridge.

LEGEND

- - +6.0 - - DESIGN FILL CONTOUR (0.5m INTERVAL)
- 10.0 — DESIGN F.S.L. SURFACE LEVEL CONTOUR (0.5m INTERVAL)
- AREA OF FILL
- FOR RETAINING WALL CONSTRUCTION DETAIL
SEE ENGINEERING CIVIL O.P.W. PLANS

Builders Note:

Builders shall not build off the design levels shown; a site survey is required. This note is an integral part of this plan.

Engineering Note:

Engineering design information supplied by PeakUrban. August 2019.

Compaction Statement:

All earthworks shall be undertaken in accordance with AS3798:2007 and local authority requirements, including Level 1 supervision.

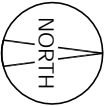

Local Authority : Logan City	
Height Datum : AHD	
Height Origin: PM153245 RL 42.221	
Contour Interval : 0.5 m	
Horizontal Meridian: MGA (Zone 56)	
ENG : Disclosure Info_20190808	
BDY : 138567 Bdy (2019-08-22)	
Surveyor: RPS GC	
Drawn : BJB	
Scale : 1:150 @ A3	
Date: 22 AUGUST 2019	
Dwg No: 144169-DISC-1/15	

Koplick Developments Pty Ltd



RPS Australia East Pty Ltd
ACN 140 292 762
ABN 44 140 292 762

Lakeside Corporate Space, Suite 425, Level 2
Building 4, 34-36 Glenferrie Drive,
Rothina PO Box 1048 Rothina DC, Qld 4226

©COPYRIGHT PROTECTS THIS PLAN
Unauthorized reproduction or amendment
not permitted. Please contact the author.

T +61 7 555 36900
F +61 7 555 36999
W rpsgroup.com

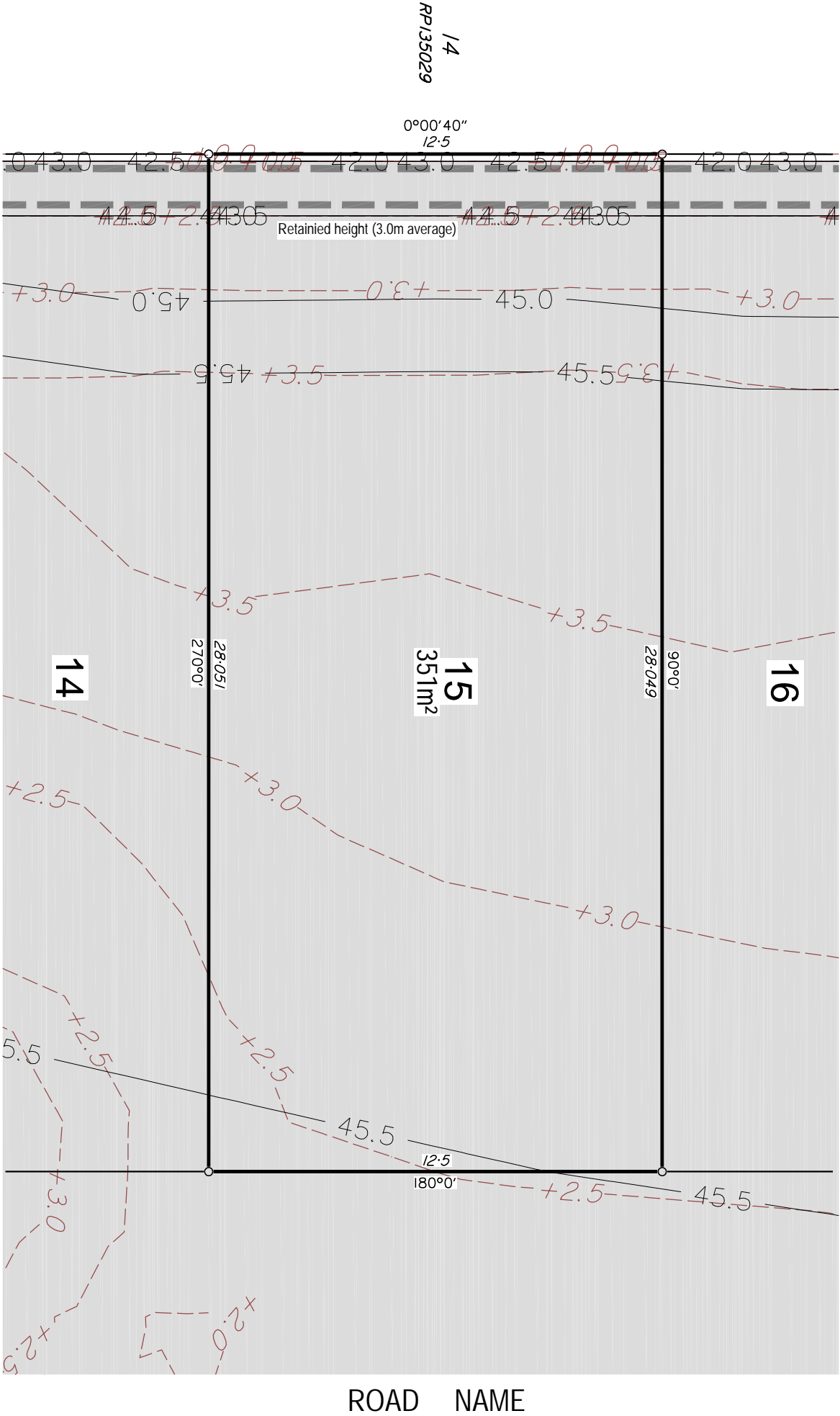

Note:
This plan has been prepared by RPS Australia East Pty Ltd (ACN 140 292 762), which is registered with the Surveyors Board of Queensland as a Cadastral Surveyor.

DISCLOSURE PLAN

FOR PROPOSED LOT 16

Proposed Lot 16 is currently described as part of Lot 15 on RP899708 situated at Koplick Road, Park Ridge.

LEGEND

- - +6.0 - - DESIGN FILL CONTOUR (0.5m INTERVAL)
- 10.0 — DESIGN F.S.L. SURFACE LEVEL CONTOUR (0.5m INTERVAL)
- AREA OF FILL
- FOR RETAINING WALL CONSTRUCTION DETAIL
SEE ENGINEERING CIVIL O.P.W. PLANS

Builders Note:

Builders shall not build off the design levels shown; a site survey is required. This note is an integral part of this plan.

Engineering Note:

Engineering design information supplied by PeakUrban. August 2019.

Compaction Statement:

All earthworks shall be undertaken in accordance with AS3798:2007 and local authority requirements, including Level 1 supervision.

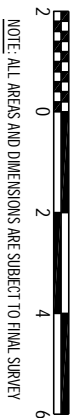

Local Authority : Logan City	
Height Datum : AHD	
Height Origin: PM153245 RL 42.221	
Contour Interval : 0.5 m	
Horizontal Meridian: MGA (Zone 56)	
ENG : Disclosure Info_20190808	
BDY : 138567 Bdy (2019-08-22)	
Surveyor: RPS GC	
Drawn : BJB	
Scale : 1:150 @ A3	
Date: 22 AUGUST 2019	
Dwg No: 144169-DISC-1/16	

Koplick Developments Pty Ltd



RPS Australia East Pty Ltd
ACN 140 292 762
ABN 44 140 292 762
Lakeside Corporate Space, Suite 425, Level 2
Building 4, 34-36 Glenferrie Drive,
Rdolina PO Box 1048 Rodina DC, Qld 4226

T +61 7 555 36900
F +61 7 555 36999
W rpsgroup.com

©COPYRIGHT PROTECTS THIS PLAN
Unauthorized reproduction or amendment
not permitted. Please contact the author.

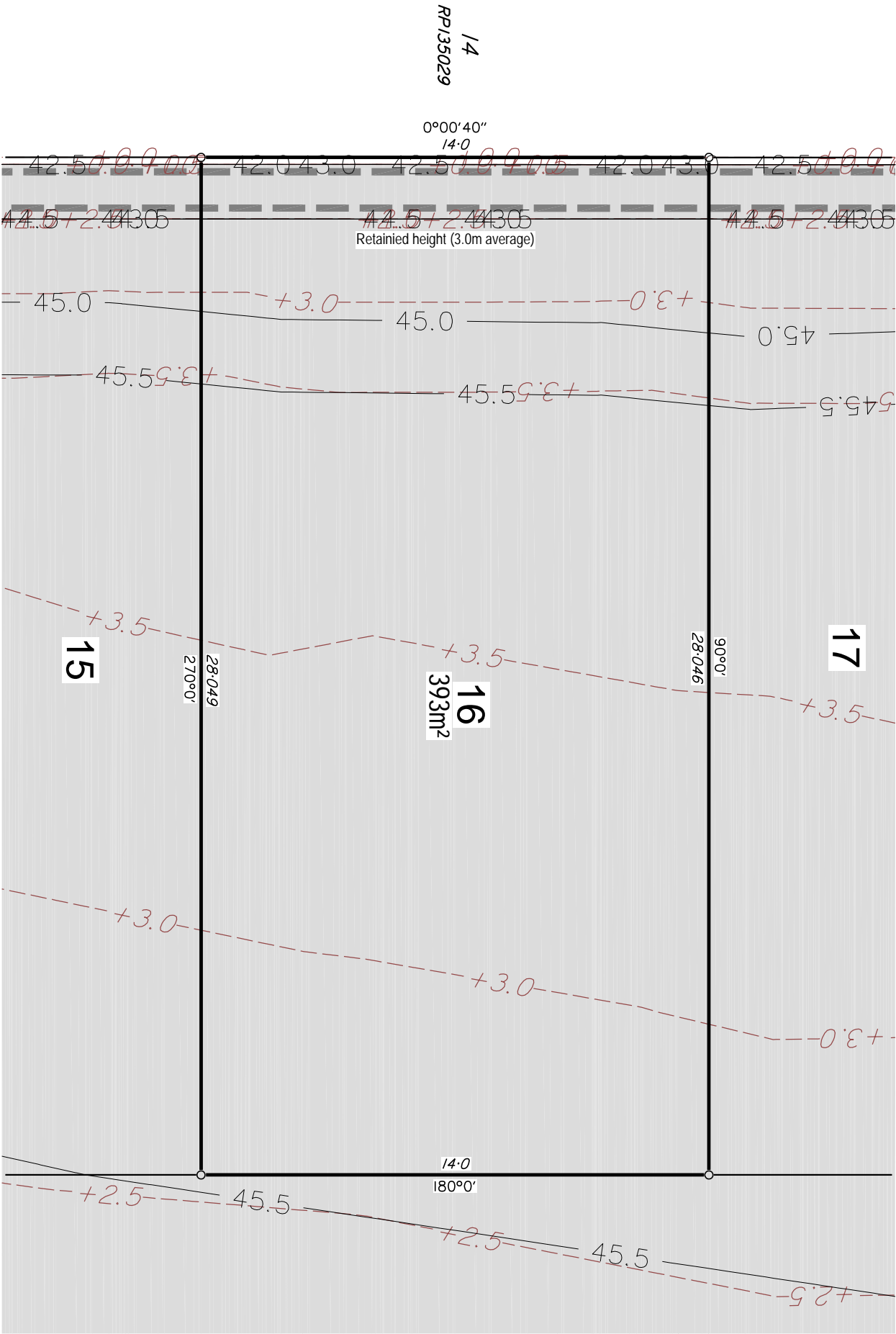

Note:
This plan has been prepared by RPS Australia East Pty Ltd (ACN 140 292 762), which is registered with the Surveyors Board of Queensland as a Cadastral Surveyor.

DISCLOSURE PLAN

FOR PROPOSED LOT 17

Proposed Lot 17 is currently described as part of Lot 15 on RP899708 situated at Koplick Road, Park Ridge.

LEGEND

- +6.0--- DESIGN FILL CONTOUR (0.5m INTERVAL)
- 10.0—— DESIGN F.S.L. SURFACE LEVEL CONTOUR (0.5m INTERVAL)
- AREA OF FILL
- FOR RETAINING WALL CONSTRUCTION DETAIL
SEE ENGINEERING CIVIL O.P.W. PLANS

Builders Note:

Builders shall not build off the design levels shown; a site survey is required. This note is an integral part of this plan.

Engineering Note:

Engineering design information supplied by PeakUrban. August 2019.

Compaction Statement:

All earthworks shall be undertaken in accordance with AS3798:2007 and local authority requirements, including Level 1 supervision.

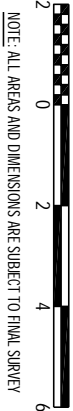

NOTE: ALL AREAS AND DIMENSIONS ARE SUBJECT TO FINAL SURVEY

Koplick Developments Pty Ltd

Local Authority : Logan City
Height Datum : AHD
Height Origin: PM153245 RL 42.221
Contour Interval : 0.5 m
Horizontal Meridian: MGA (Zone 56)
ENG : Disclosure Info_20190808
BDY : 138567 Bdy (2019-08-22)
Surveyor: RPS GC
Drawn : BJB
Scale : 1:150 @ A3
Date: 22 AUGUST 2019
Dwg No: 144169-DISC-1/17

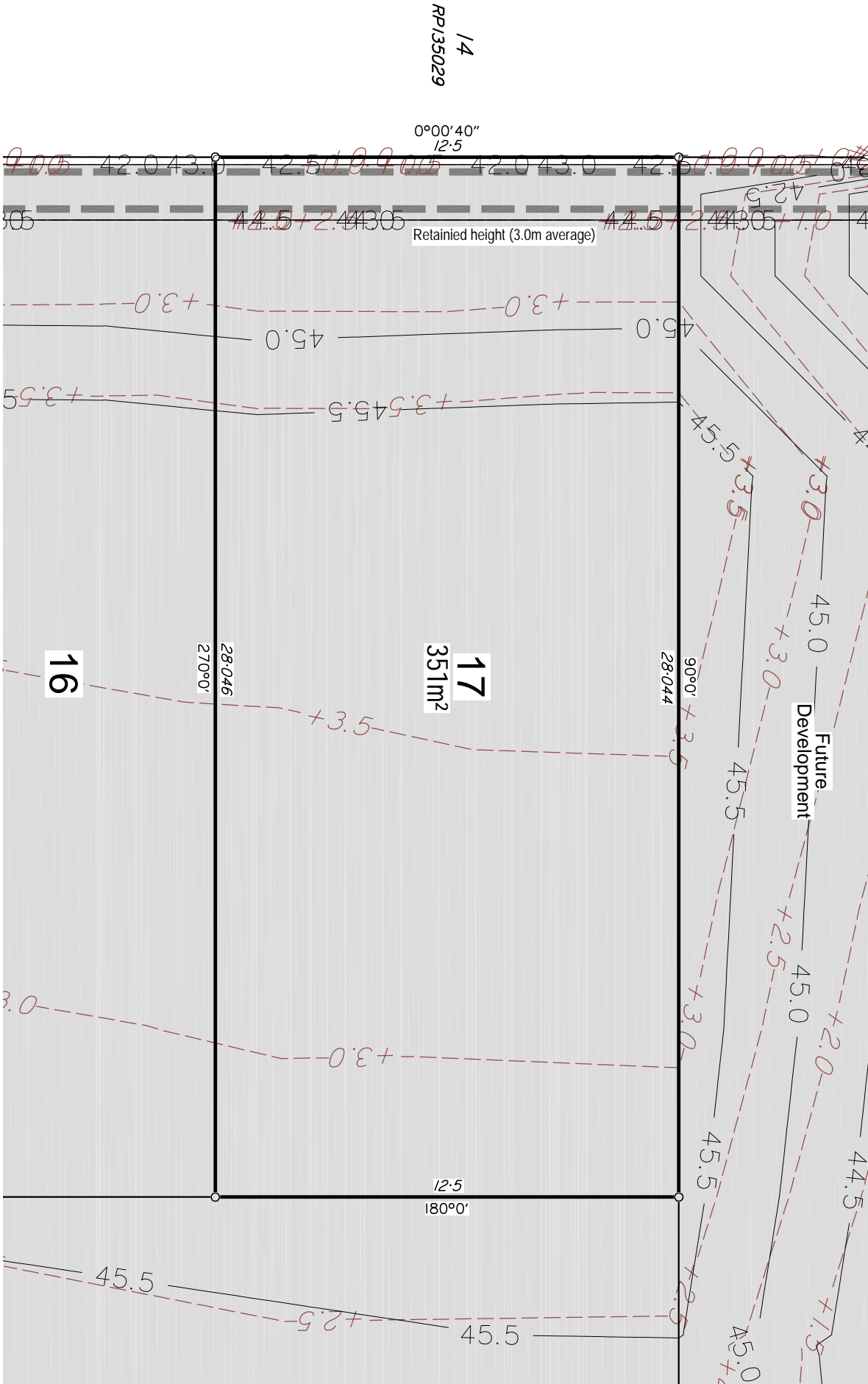

1/4
RP135029

Note:
This plan has been prepared by RPS Australia East Pty Ltd (ACN 140 292 762), which is registered with the Surveyors Board of Queensland as a Cadastral Surveyor.

DISCLOSURE PLAN

FOR PROPOSED LOT 17

Proposed Lot 17 is currently described as part of Lot 15 on RP899708 situated at Koplick Road, Park Ridge.

LEGEND

- +6.0--- DESIGN FILL CONTOUR (0.5m INTERVAL)
- 10.0—— DESIGN F.S.L. SURFACE LEVEL CONTOUR (0.5m INTERVAL)
- AREA OF FILL
- FOR RETAINING WALL CONSTRUCTION DETAIL
SEE ENGINEERING CIVIL O.P.W. PLANS

Builders Note:

Builders shall not build off the design levels shown; a site survey is required. This note is an integral part of this plan.

Engineering Note:

Engineering design information supplied by PeakUrban. August 2019.

Compaction Statement:

All earthworks shall be undertaken in accordance with AS3798:2007 and local authority requirements, including Level 1 supervision.

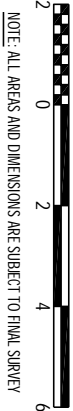

NOTE: ALL AREAS AND DIMENSIONS ARE SUBJECT TO FINAL SURVEY

Koplick Developments Pty Ltd

Local Authority : Logan City
Height Datum : AHD
Height Origin: PM153245 RL 42.221
Contour Interval : 0.5 m
Horizontal Meridian: MGA (Zone 56)
ENG : Disclosure Info_20190808
BDY : 138567 Bdy (2019-08-22)
Surveyor: RPS GC
Drawn : BJB
Scale : 1:150 @ A3
Date: 22 AUGUST 2019
Dwg No: 144169-DISC-1/17

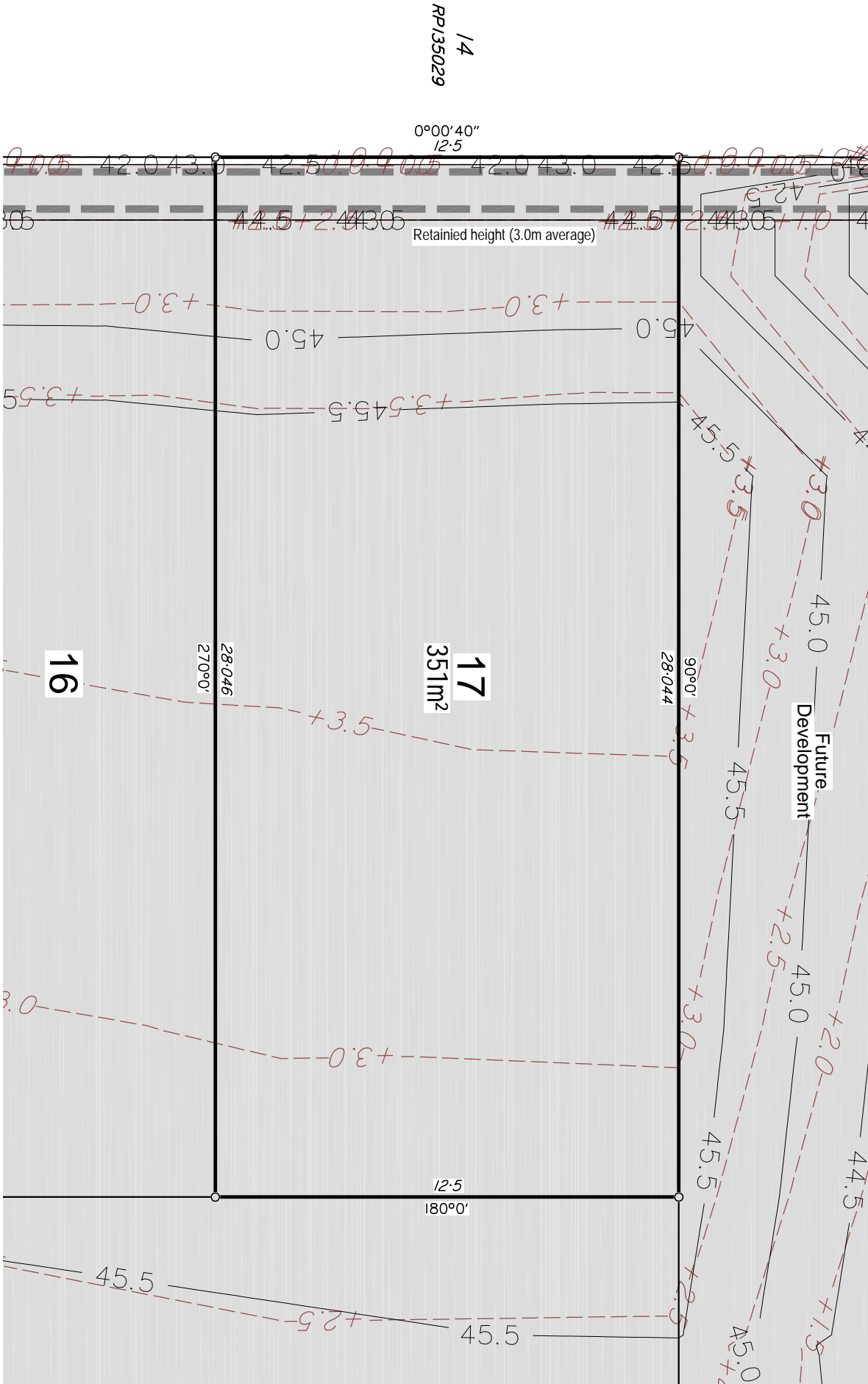

1/4
RP135029

Note:
This plan has been prepared by RPS Australia East Pty Ltd (ACN 140 292 762), which is registered with the Surveyors Board of Queensland as a Cadastral Surveyor.



RPS Australia East Pty Ltd
ACN 140 292 762
ABN 44 140 292 762
Lakeside Corporate Space, Suite 425, Level 2
Building 4, 34-36 Glenferrie Drive,
Rothina PO Box 1048 Rothina DC, Qld 4226
T +61 7 555 36900
F +61 7 555 36999
W rpsgroup.com

©COPYRIGHT PROTECTS THIS PLAN
Unauthorized reproduction or amendment
not permitted. Please contact the author.

DISCLOSURE PLAN

FOR PROPOSED LOT 66

Proposed Lot 66 is currently described as part of Lot 15 on RP899708 situated at Koplick Road, Park Ridge.

LEGEND

- +6.0--- DESIGN FILL CONTOUR (0.5m INTERVAL)
- 10.0—— DESIGN F.S.L. SURFACE LEVEL CONTOUR (0.5m INTERVAL)
- AREA OF FILL
- FOR RETAINING WALL CONSTRUCTION DETAIL
SEE ENGINEERING CIVIL O.P.W. PLANS

Builders Note:

Builders shall not build off the design levels shown; a site survey is required. This note is an integral part of this plan.

Engineering Note:

Engineering design information supplied by PeakUrban. August 2019.

Compaction Statement:

All earthworks shall be undertaken in accordance with AS3798:2007 and local authority requirements, including Level 1 supervision.

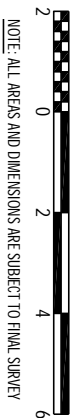

Local Authority : Logan City	
Height Datum : AHD	
Height Origin: PM153245 RL 42.221	
Contour Interval : 0.5 m	
Horizontal Meridian: MGA (Zone 56)	
ENG : Disclosure Info_20190808	
BDY : 138567 Bdy (2019-08-22)	
Surveyor: RPS GC	
Drawn : BJB	
Scale : 1:150 @ A3	
Date: 22 AUGUST 2019	
Dwg No: 144169-DISC-I/66	

Koplick Developments Pty Ltd



RPS Australia East Pty Ltd
ACN 140 292 762
ABN 44 140 292 762

Lakeside Corporate Space, Suite 425, Level 2
Building 4, 34-36 Glenferrie Drive,
Rdolina PO Box 1048 Rdolina DC, Qld 4226

T +61 7 555 36900
F +61 7 555 36999
W rpsgroup.com

©COPYRIGHT PROTECTS THIS PLAN
Unauthorized reproduction or amendment
not permitted. Please contact the author.

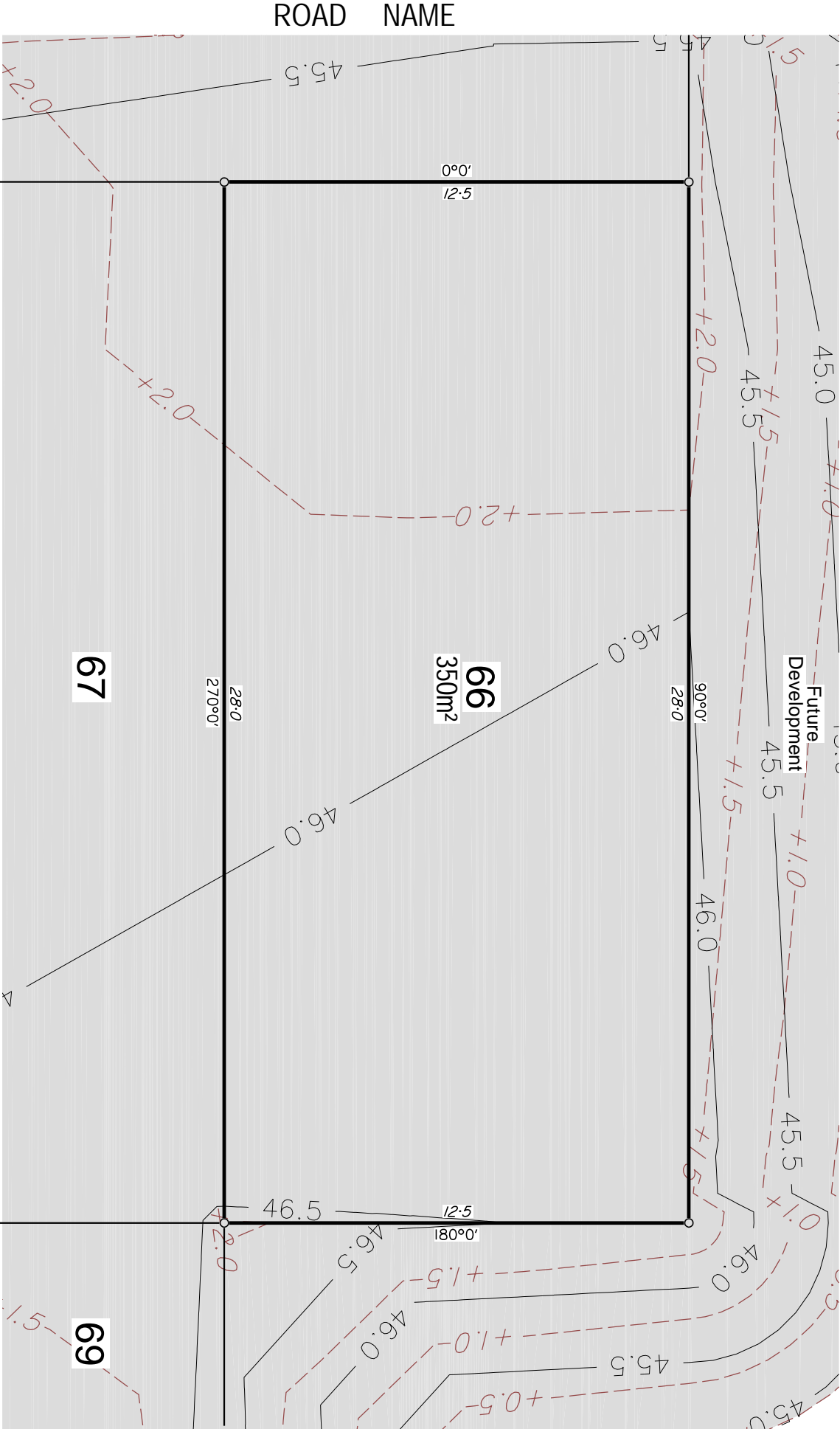

Note:

This plan has been prepared by RPS Australia East Pty Ltd (ACN 140 292 762), which is registered with the Surveyors Board of Queensland as a Cadastral Surveyor.

DISCLOSURE PLAN

FOR PROPOSED LOT 67

Proposed Lot 67 is currently described as part of Lot 15 on RP899708 situated at Koplick Road, Park Ridge.

LEGEND

- +6.0--- DESIGN FILL CONTOUR (0.5m INTERVAL)
- 10.0—— DESIGN F.S.L. SURFACE LEVEL CONTOUR (0.5m INTERVAL)
- AREA OF FILL
- FOR RETAINING WALL CONSTRUCTION DETAIL
SEE ENGINEERING CIVIL O.P.W. PLANS

Builders Note:

Builders shall not build off the design levels shown; a site survey is required. This note is an integral part of this plan.

Engineering Note:

Engineering design information supplied by PeakUrban. August 2019.

Compaction Statement:

All earthworks shall be undertaken in accordance with AS3798:2007 and local authority requirements, including Level 1 supervision.



Local Authority : Logan City	
Height Datum : AHD	
Height Origin: PM153245 RL 42.221	
Contour Interval : 0.5 m	
Horizontal Meridian: MGA (Zone 56)	
ENG : Disclosure Info_20190808	
BDY : 138567 Bdy (2019-08-22)	
Surveyor: RPS GC	
Drawn : BJB	
Scale : 1:150 @ A3	
Date: 22 AUGUST 2019	
Dwg No: 144169-DISC-1/67	

Koplick Developments Pty Ltd



RPS Australia East Pty Ltd
ACN 140 292 762
ABN 44 140 292 762

Lakeside Corporate Space, Suite 425, Level 2
Building 4, 34-36 Glenferrie Drive,
Rothina PO Box 1048 Rothina DC, Qld 4226

©COPYRIGHT PROTECTS THIS PLAN
Unauthorised reproduction or amendment
not permitted. Please contact the author.

T +61 7 555 36900
F +61 7 555 36999
W rpsgroup.com

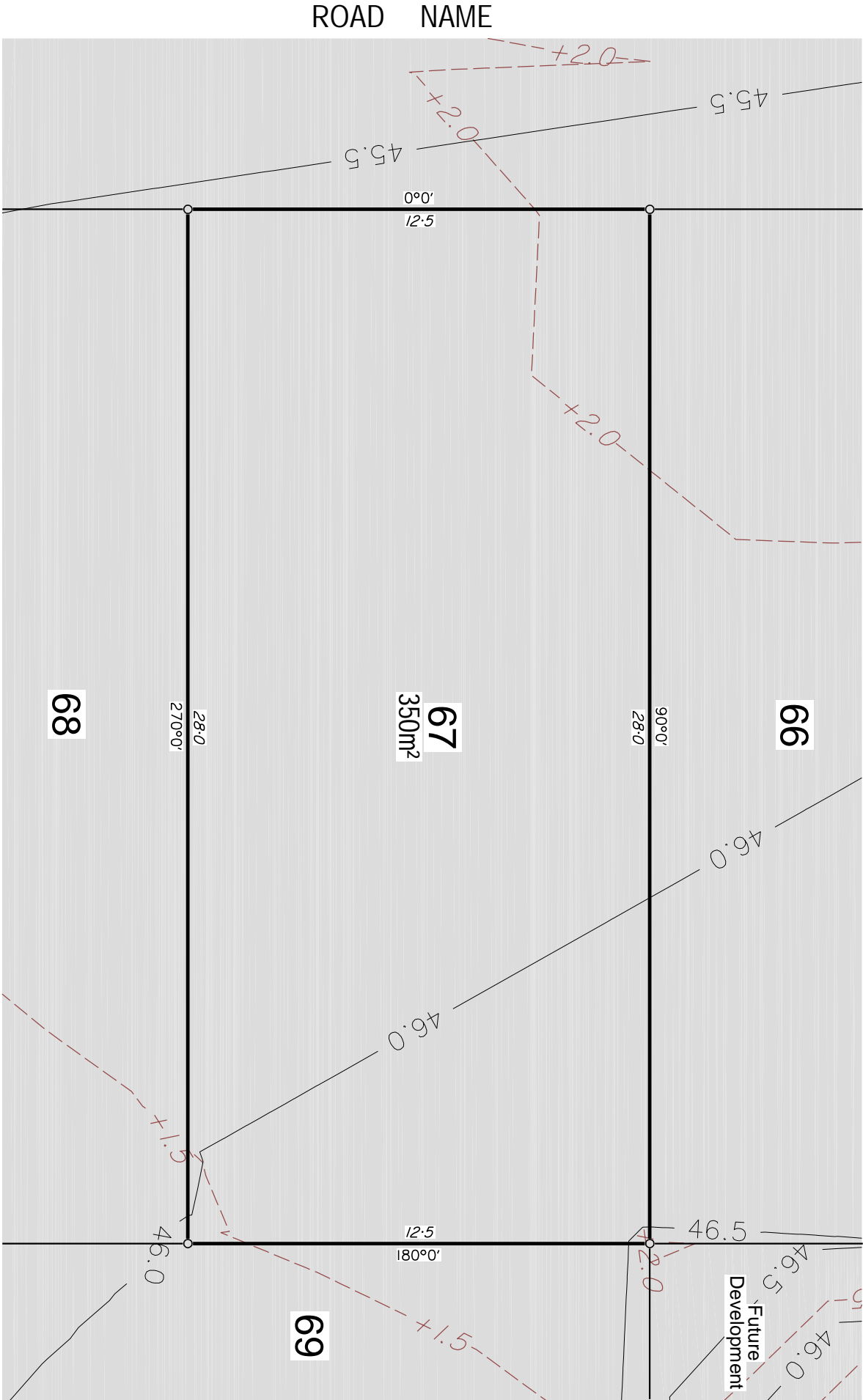

Note:

This plan has been prepared by RPS Australia East Pty Ltd (ACN 140 292 762), which is registered with the Surveyors Board of Queensland as a Cadastral Surveyor.

DISCLOSURE PLAN

FOR PROPOSED LOT 68

Proposed Lot 68 is currently described as part of Lot 15 on RP899708 situated at Koplick Road, Park Ridge.

LEGEND

- +6.0 DESIGN FILL CONTOUR (0.5m INTERVAL)
- 10.0 DESIGN F.S.L. SURFACE LEVEL CONTOUR (0.5m INTERVAL)
- AREA OF FILL
- FOR RETAINING WALL CONSTRUCTION DETAIL SEE ENGINEERING CIVIL O.P.W. PLANS

Builders Note:

Builders shall not build off the design levels shown; a site survey is required. This note is an integral part of this plan.

Engineering Note:

Engineering design information supplied by PeakUrban. November 2020.

Compaction Statement:

All earthworks shall be undertaken in accordance with AS3798:2007 and local authority requirements, including Level 1 supervision.



Local Authority : Logan City	
Height Datum : AHD	
Height Origin: PM153245 RL 42.221	
Contour Interval : 0.5 m	
Horizontal Meridian: MGA (Zone 56)	
ENG : Disclosure Info_20201117	
BDY : 144169 Bdy (2020-11-16) Overall	
Surveyor: RPS GC	
Drawn : BJB	
Scale : 1:150 @ A3	
Date: 17 NOVEMBER 2020	
Dwg No: 144169-DISC-1b/68	

Koplick Developments Pty Ltd



RPS Australia East Pty Ltd
ACN 140 292 762
ABN 44 140 292 762

Lakeside Corporate Space, Suite 425, Level 2
Building 4, 34-36 Glenferrie Drive,
Roslina PO Box 1048 Roslinda DC, Qld 4226

©COPYRIGHT PROTECTS THIS PLAN
Unauthorized reproduction or amendment
not permitted. Please contact the author.

T +61 7 555 36900
F +61 7 555 36999
W rpsgroup.com

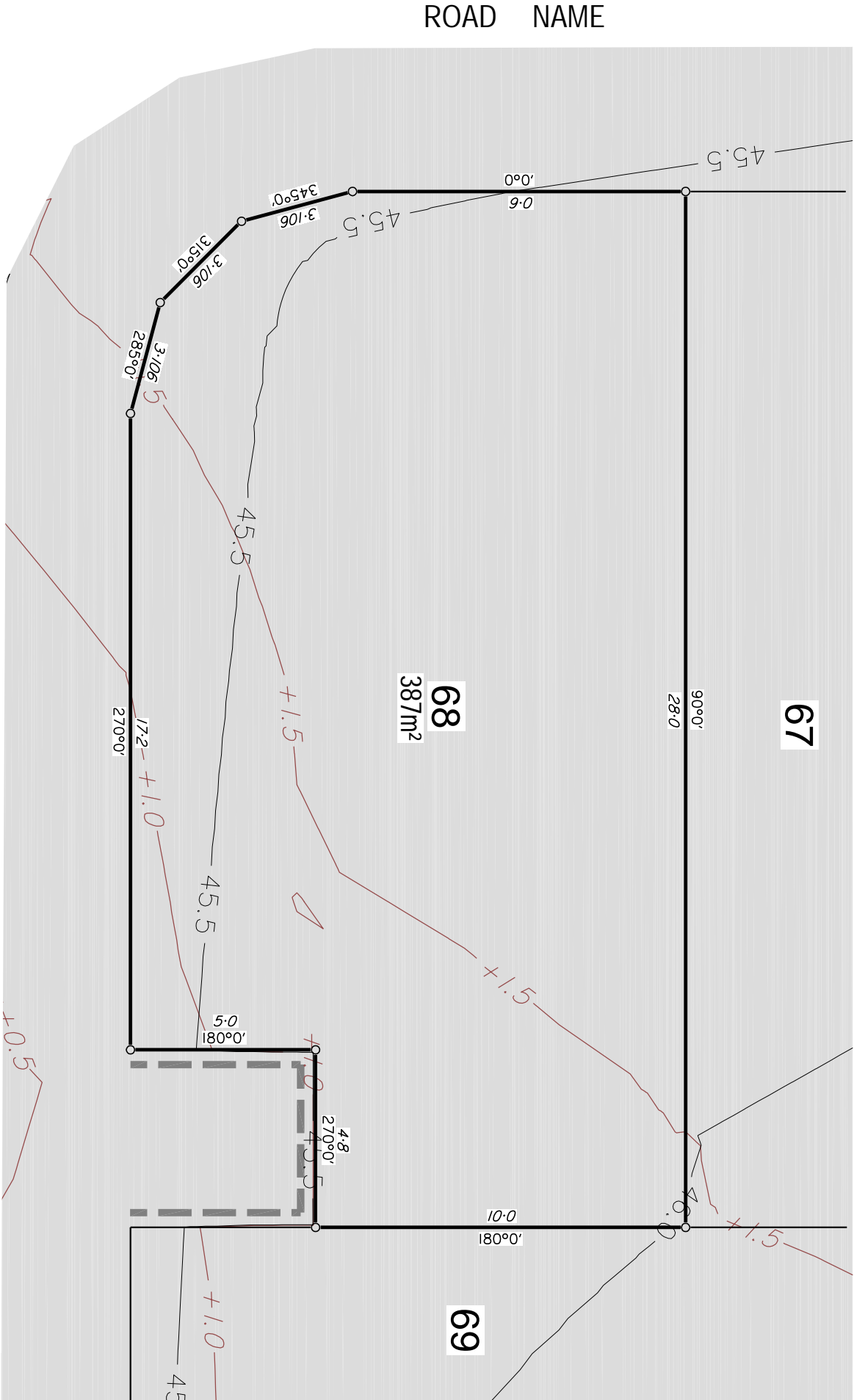

ROAD NAME

ROAD NAME

Note:

This plan has been prepared by RPS Australia East Pty Ltd (ACN 140 292 762), which is registered with the Surveyors Board of Queensland as a Cadastral Surveyor.

DISCLOSURE PLAN

FOR PROPOSED LOT 69

Proposed Lot 69 is currently described as part of Lot 15 on RP899708 situated at Koplick Road, Park Ridge.

LEGEND

- +6.0 DESIGN FILL CONTOUR (0.5m INTERVAL)
- 10.0 DESIGN F.S.L. SURFACE LEVEL CONTOUR (0.5m INTERVAL)
- AREA OF FILL
- FOR RETAINING WALL CONSTRUCTION DETAIL
- SEE ENGINEERING CIVIL O.P.W. PLANS

Builders Note:

Builders shall not build off the design levels shown: a site survey is required. This note is an integral part of this plan.

Engineering Note:

Engineering design information supplied by PeakUrban. November 2020.

Compaction Statement:

All earthworks shall be undertaken in accordance with AS3798:2007 and local authority requirements, including Level 1 supervision.

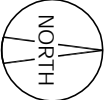

Koplick Developments Pty Ltd

Local Authority : Logan City
Height Datum : AHD
Height Origin: PM153245 RL 42.221
Contour Interval : 0.5 m
Horizontal Meridian: MGA (Zone 56)
ENG : Disclosure Info_20201117
BDY : 144169 Bdy (2020-11-16) Overall
Surveyor: RPS GC
Drawn : BJB
Scale : 1:150 @ A3
Date: 17 NOVEMBER 2020
Dwg No: 144169-DISC-1b/69



RPS Australia East Pty Ltd
ACN 140 292 762
ABN 44 140 292 762
Lakeside Corporate Space, Suite 425, Level 2
Building 4, 34-36 Glenferrie Drive,
Rothina PO Box 1048 Rothina DC, Qld 4226

©COPYRIGHT PROTECTS THIS PLAN
Unauthorised reproduction or amendment
not permitted. Please contact the author.

T +61 7 555 36900
F +61 7 555 36999
W rpsgroup.com

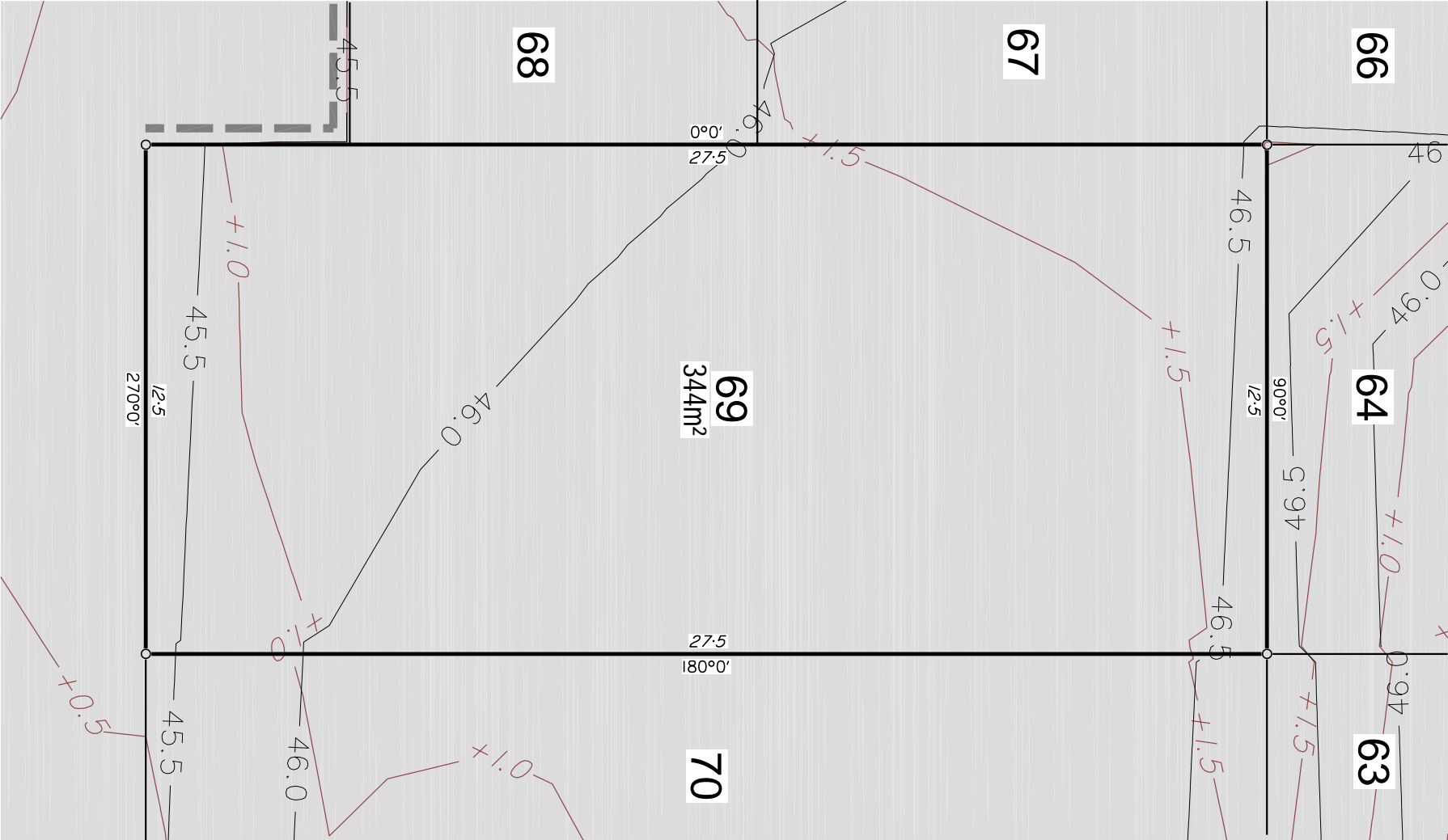

ROAD NAME

Note:

This plan has been prepared by RPS Australia East Pty Ltd (ACN 140 292 762), which is registered with the Surveyors Board of Queensland as a Cadastral Surveyor.

DISCLOSURE PLAN

FOR PROPOSED LOT 70

Proposed Lot 70 is currently described as part of Lot 15 on RP899708 situated at Koplick Road, Park Ridge.

LEGEND

- +6.0 DESIGN FILL CONTOUR (0.5m INTERVAL)
- 10.0 DESIGN F.S.L. SURFACE LEVEL CONTOUR (0.5m INTERVAL)
- AREA OF FILL
- FOR RETAINING WALL CONSTRUCTION DETAIL
SEE ENGINEERING CIVIL O.P.W. PLANS

Builders Note:

Builders shall not build off the design levels shown; a site survey is required. This note is an integral part of this plan.

Engineering Note:

Engineering design information supplied by PeakUrban. November 2020.

Compaction Statement:

All earthworks shall be undertaken in accordance with AS3798:2007 and local authority requirements, including Level 1 supervision.

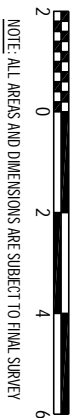

NOTE: ALL AREAS AND DIMENSIONS ARE SUBJECT TO FINAL SURVEY

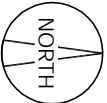

Local Authority : Logan City	
Height Datum : AHD	
Height Origin: PM153245 RL 42.221	
Contour Interval : 0.5 m	
Horizontal Meridian: MGA (Zone 56)	
ENG : Disclosure Info_20201117	
BDY : 144169 Bdy (2020-11-16) Overall	
Surveyor: RPS GC	
Drawn : BJB	
Scale : 1:150 @ A3	
Date: 17 NOVEMBER 2020	
Dwg No: 144169-DISC-1b/70	

Koplick Developments Pty Ltd



RPS Australia East Pty Ltd
ACN 140 292 762
ABN 44 140 292 762

Lakeside Corporate Space, Suite 425, Level 2
Building 4, 34-36 Glenferrie Drive,
Rothina PO Box 1048 Rothina DC, Qld 4226

T +61 7 555 36900
F +61 7 555 36999
W rpsgroup.com

©COPYRIGHT PROTECTS THIS PLAN
Unauthorized reproduction or amendment
not permitted. Please contact the author.

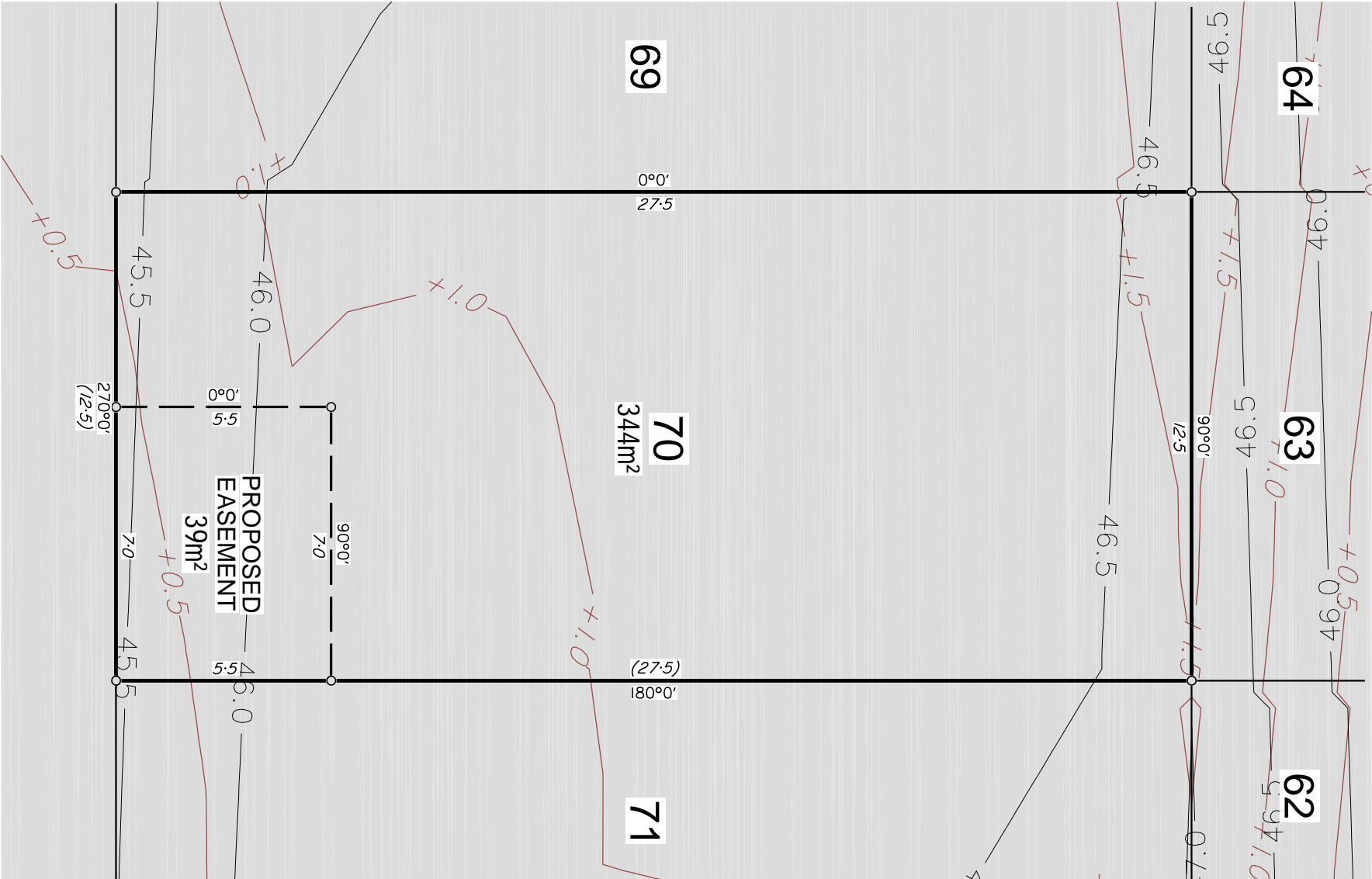

ROAD NAME

Note:

This plan has been prepared by RPS Australia East Pty Ltd (ACN 140 292 762), which is registered with the Surveyors Board of Queensland as a Cadastral Surveyor.

DISCLOSURE PLAN

FOR PROPOSED LOT 71

Proposed Lot 71 is currently described as part of Lot 15 on RP899708 situated at Koplick Road, Park Ridge.

LEGEND

- +6.0 DESIGN FILL CONTOUR (0.5m INTERVAL)
- 10.0 DESIGN F.S.L. SURFACE LEVEL CONTOUR (0.5m INTERVAL)
- AREA OF FILL
- FOR RETAINING WALL CONSTRUCTION DETAIL
SEE ENGINEERING CIVIL O.P.W. PLANS

Builders Note:

Builders shall not build off the design levels shown; a site survey is required. This note is an integral part of this plan.

Engineering Note:

Engineering design information supplied by PeakUrban. November 2020.

Compaction Statement:

All earthworks shall be undertaken in accordance with AS3798:2007 and local authority requirements, including Level 1 supervision.

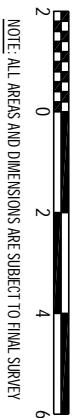

NOTE: ALL AREAS AND DIMENSIONS ARE SUBJECT TO FINAL SURVEY

Local Authority : Logan City

Height Datum : AHD

Height Origin: PM153245 RL 42.221

Contour Interval : 0.5 m

Horizontal Meridian: MGA (Zone 56)

ENG : Disclosure Info_20201117

BDY : 144169 Bdy (2020-11-16) Overall

Surveyor: RPS GC

Drawn : BJB

Scale : 1:150 @ A3

Date: 17 NOVEMBER 2020

Dwg No: 144169-DISC-1b/71

Koplick Developments Pty Ltd



RPS Australia East Pty Ltd
ACN 140 292 762
ABN 44 140 292 762

Lakeside Corporate Space, Suite 425, Level 2
Building 4, 34-36 Glenferrie Drive,
Rdolina PO Box 1048 Rdolina DC, Qld 4226

©COPYRIGHT PROTECTS THIS PLAN
Unauthorised reproduction or amendment
not permitted. Please contact the author.

T +61 7 555 36900
F +61 7 555 36999
W rpsgroup.com

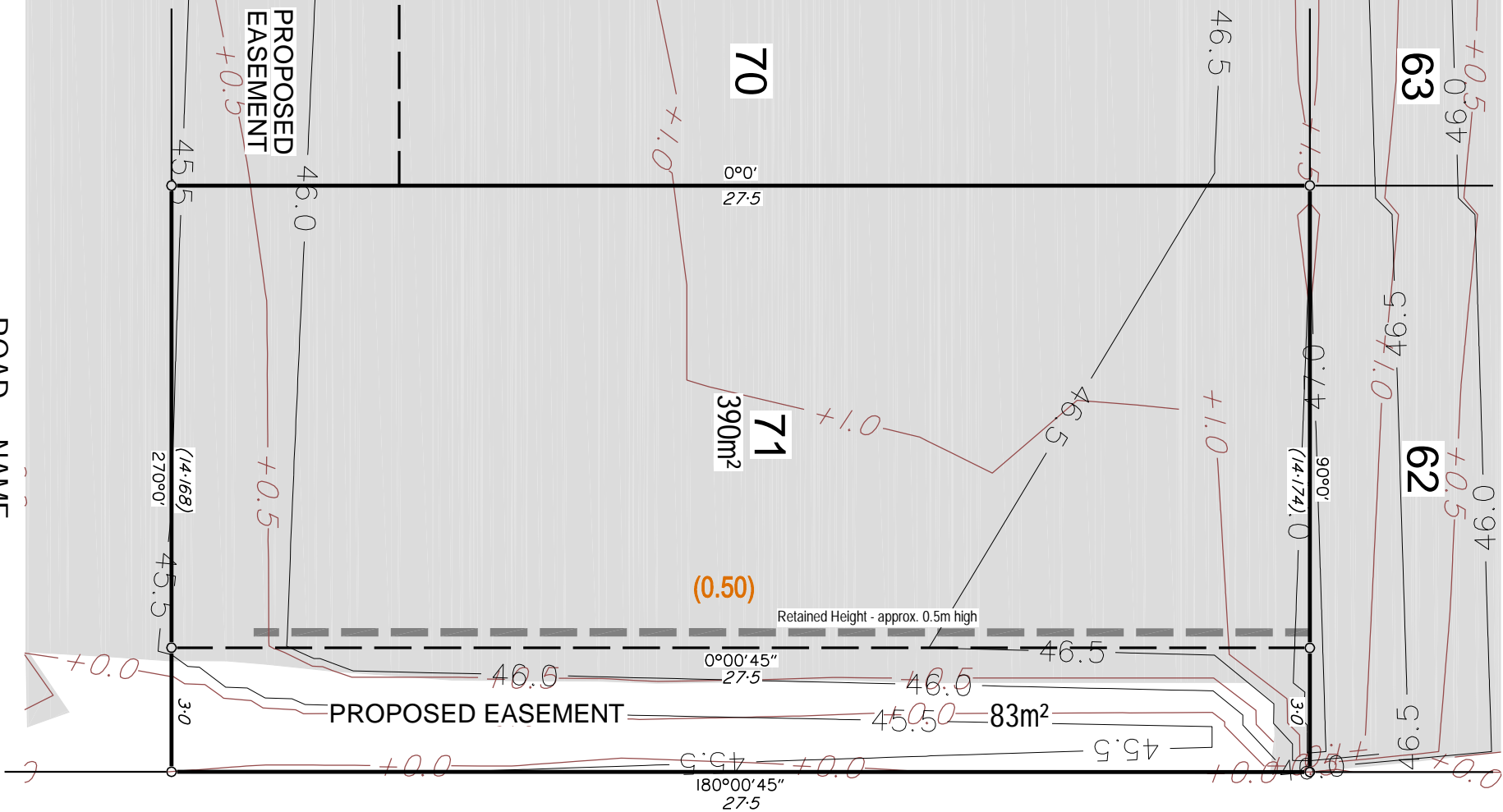

1/6

RP135029

Note:

This plan has been prepared by RPS Australia East Pty Ltd (ACN 140 292 762), which is registered with the Surveyors Board of Queensland as a Cadastral Surveyor.